

DAI MT CB H660 1980x700 T BT/TN SP60 PL 230/50

66509132

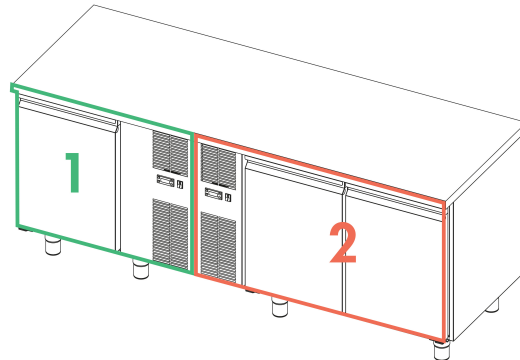

DIMENSIONS AND WEIGHTS

External dimensions in mm. (LxPxH): 1980x700x850

Net/gross weight in Kg.: 160/192

Through-in door dimensions in mm. (LxP): 362x542

Capacity (Liters): 120+180

Packaging dimensions in mm. (LxPxH): 2300x750x1100

Insulation thickness: 60 mm

TECHNICAL FEATURES

Voltage: 230V / 50Hz / 1

Defrosting: Automatic

Electronic temperature control device: Yes

Condensation discharge: Automatic

Construction materials: Stainless steel aisi 304 with external bottom on zinc plated steel and back on stainless steel aisi 430

EVAPORATION RESISTANCE: /

LIGHTING ABSORPTION: /

Freon (section 2): R290

Refrigerant charge (section 2): 0,085

Out put (Section 2): 335W

Absorption (Section 2): 272W / 1,61A

DEFROSTING RESISTANCE (Section 2): /

Freon (section 1): R290

Refrigerant charge (section 1): 0,070

Out put (Section 1): 220W

Absorption (Section 1): 337W / 2,25A

DEFROSTING RESISTANCE (Section 1): 600

GENERAL FEATURES

Refrigeration system : vetilata

Built-in motor: Yes

On castors: On demand

Lighting: No

Door with magnetic seal: Yes

Doors with return: Yes

Equipment grate: 3 x GN 1/1

Working temperature (section 2): 0°/+8°C

Working temperature (section 1): -18°/-22°C

ENERGETIC FEATURES

Climate class: 5 (40°C - 40%)

Typology: Horizontal Cabinet

Performance: High performance - This appliance is intended for use in ambient temperatures up to 40 ° C

Category (Section 1): Storage

Category (Section 2): Storage

Refrigeration Volume Vnref (L) (Section 2): 176

Freezing Volume Vnfrz (L) (Section 2): -

Daily power consumption E24 h (Section 2): 1,18

Annual absorption AEC KWh/Annum (Section 2): 431

Refrigeration Volume Vnref (L) (Section 1): -

Freezing Volume Vnfrz (L) (Section 1): 88

Daily power consumption E24 h (Section 1): 5,40

Annual absorption AEC KWh/Annum (Section 1): 1971

IEE energy efficiency index: 68,11

STUDIO 54 SRL

Via Gian Lorenzo Bernini 147 - 35010 San Giorgio in Bosco PD

T +39 049 9450466 - F +39 0499451044 - Cod. fiscale e p.iva 00096970280 - R.E.A. n. 247856

www.studio-54.it info@studio-54.it

TECHNICAL DESIGN

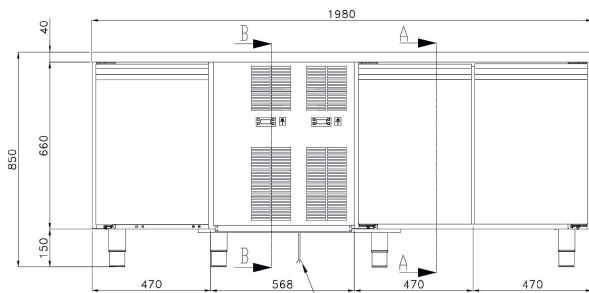

USCITA CAVO ALIMENTAZIONE
230V/50Hz/1N L=3000mm
+ SPINA SHUKO FORNITA

POWER CABLE OUTLET
230V/50Hz/1N L=3000mm
+ SCHUKO PLUG SUPPLIED

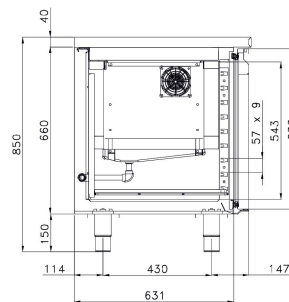

691

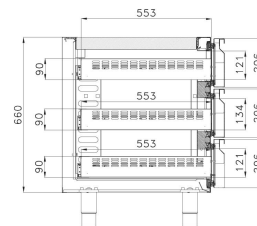
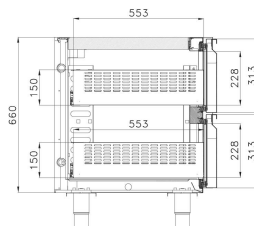
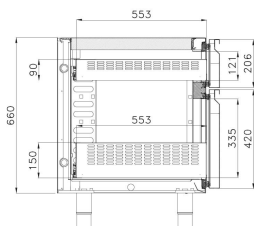
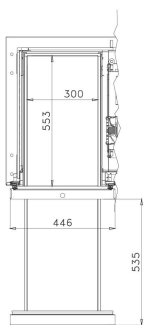
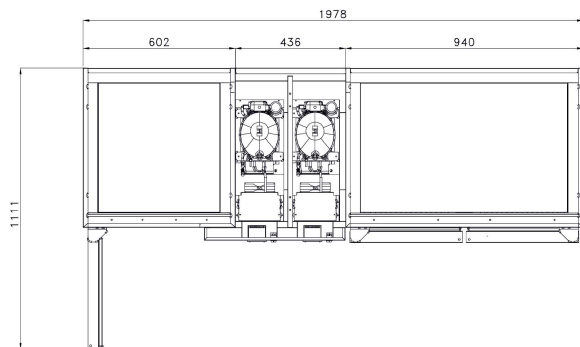
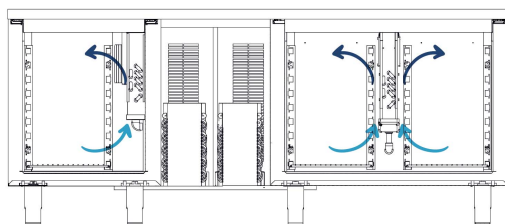
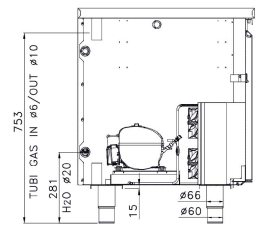

OPTIONAL

STUDIO 54 SRL

Via Gian Lorenzo Bernini 147 - 35010 San Giorgio in Bosco PD
T +39 049 9450466 - F +39 0499451044 - Cod. fiscale e p.iva 00096970280 - R.E.A. n. 247856
www.studio-54.it info@studio-54.it